

SEE SHEET TWO  
FOR LEAD OPTIONS

NOTES:

1. ROTOR & STATOR ARE A MATCHED PAIR. DO NOT INTERCHANGE ROTOR OR STATOR BETWEEN RESOLVERS.
2. ROTOR AND STATOR TO BE AXIALLY ALIGNED TO DATUM "B" ± .015.
3. CUSTOMER MUST MAINTAIN SHAFT RUNOUT WITH RESPECT TO DATUM 'A' WITHIN .003 T.I.R.

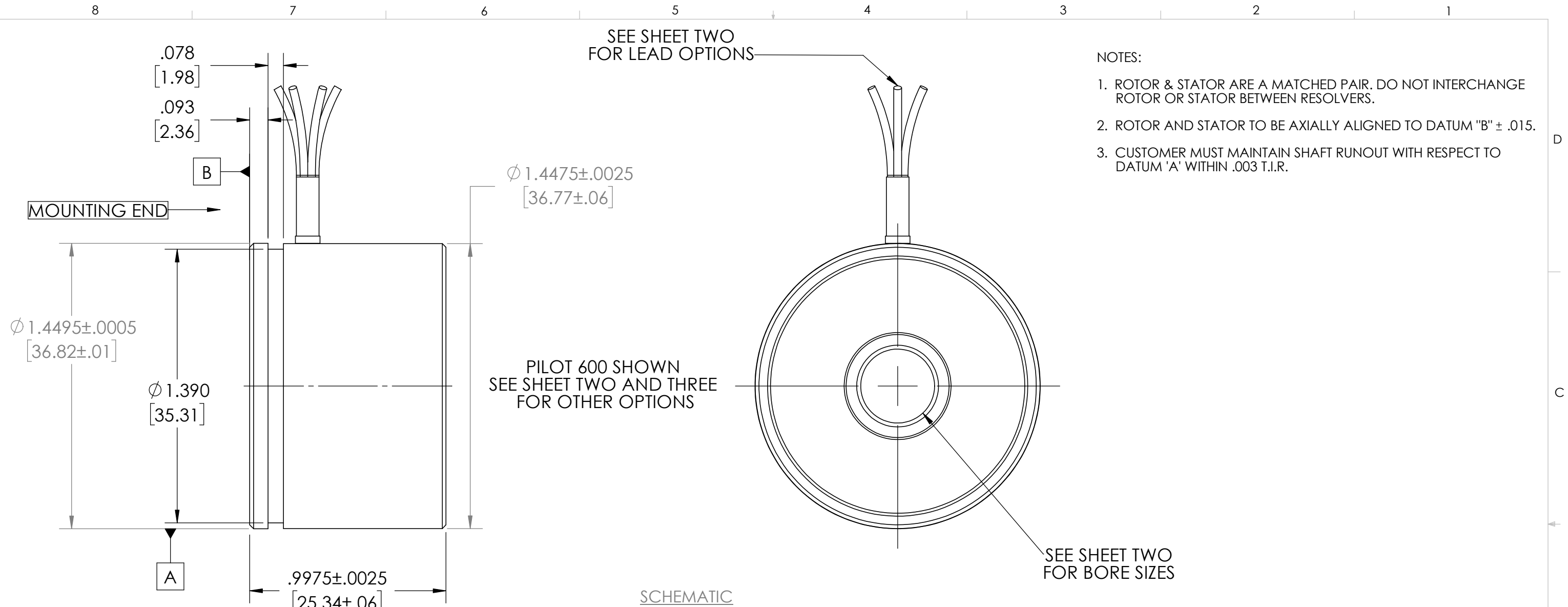

SCHEMATIC

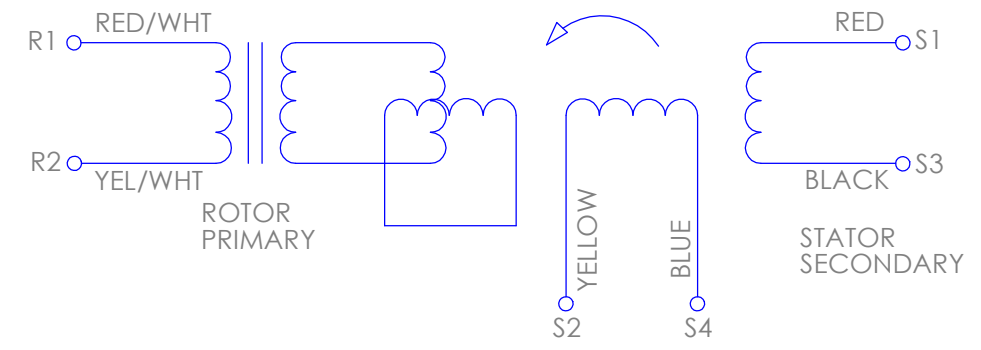

PHASING EQUATION

FOR CCW ROTATION OF ROTOR FACING TRANSFORMER MOUNTING FLANGE END.

$$E(S1-S3) = KE(R1-R2) \cos \theta$$

$$E(S2-S4) = -KE(R1-R2) \sin \theta$$

TECHNICAL INFORMATION		
HIPOT, LEADS TO CASE, 500VAC	Max. mAmps	2
HIPOT, INTERPHASE, 250VAC	Max. mAmps	2
TEMPERATURE RANGE	°C	-55 TO 155
WEIGHT, APPROX	oz	3

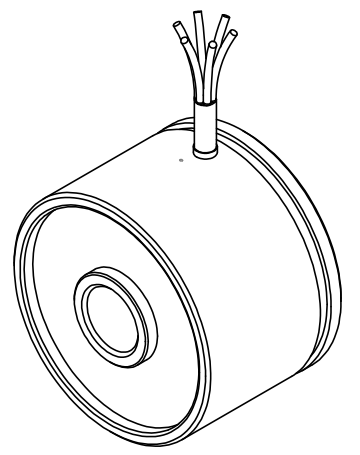

THIRD ANGLE PROJECTION

THE INFORMATION CONTAINED IN THIS DRAWING IS THE SOLE PROPERTY OF API DELEVAN. ANY REPRODUCTION IN PART OR WHOLE WITHOUT THE WRITTEN PERMISSION OF API DELEVAN IS PROHIBITED.

UNLESS OTHERWISE SPECIFIED: DIMENSIONS ARE IN INCHES [mm] DIAMETERS CONCENTRIC -.003 [.076] TIR FACES PERPENDICULAR -.003 [.076] INSIDE CORNERS R .015 [.381] MAX INTERPRETATION PER ASME Y14.5M-1994		UNLESS OTHERWISE SPECIFIED: REMOVE ALL BURRS AND BREAK SHARP EDGES -.005/.010[.127/.254]	
MATERIAL	-	MACHINE SURFACES	63
FINISH	-	APPROVALS	DATE
		CHECKED	-
		DES ENG	-

**API DELEVAN**  
<http://www.delevan.com>

**15BRCX**

SIZE B DWG. NO. \_\_\_\_\_

SCALE \_\_\_\_\_ SHEET 1 OF 3 C.CODE IDENT: 99800

**PART, ASSEMBLY AND ALL COMPONENTS  
MEET EU ROHS DIRECTIVE**

REVISIONS					
REV	ECO	DESCRIPTION	DATE	BY	CHECKED
-	-	NEW DRAWING			

# NUMBERING

## 15BRCX-XXX-XXXXX-XXXX

PLEASE CONTACT FACTORY FOR OTHER ELECTRICAL AND MECHANICAL OPTIONS.

SIZE  
15

STYLE OF RESOLVER:  
FRAMELESS

PILOT NUMBER	STYLE	WINDING NUMBER	Vrms	KHz	ma Arms	Tr	SPEED	ACCURACY ±arcmin	BORE LETTER	BORE	DIAMETER	CABLE DESIGNATION	CABLE	LEAD	LENGTH
600	SERVO GROOVE ALUMINUM, 1.0 [26.40], Ø1.449 [36.80]	001	10	4.5	58	.50	1	10	D	3/8	.375/.376 [9.53/9.55] 1.0 [25.4] AOL	02	28 AWG FLYING LEADS	01	12 [305]
		035	7	8	50	.50	1	10	K	3/8	.375/.376 [9.53/9.55] .635 [16.13] AOL	05	26 AWG FLYING LEADS	02	16 [406]
		002	7	10	40	.50	1	20 SPREAD	Q	1/4	.2500/.2510 [6.35/6.375] .625-1.0 [25.4] AOL	06	28 AWG 3 TWISTED PAIRS W/DRAIN	03	24 [609]
602	SERVO GROOVE ALUMINUM, .635 [16.13], Ø1.449 [36.80]	004	4	10	16	.474	2	20 SPREAD	S	7/16	.4370/.4380 {11.10} 1.53 [38.86] AOL	07	24 AWG FLYING LEADS W/SHIELDING	04	60 [1524]
		006	4	5	23	.5	1	15	W	8mm	.3149/.3157 [7.99/8.02], .635 [16.13] AOL	08	28AWG FLYING LEADS HIGH TEMP	05	80 [2032]
		007	2	6	45	1	1	7	AC	10 mm	.3937/.3945 [10.0/10.02] .635 [16.13] AOL	09	24 AWG 3 TWISTED PAIRS	06	120 [3048]
009	4.25	7	55	.47	1	7	AM	3/8	.375/.376 [9.53/9.55] W/KEYWAY .635 [16.13] AOL	11	22 AWG 4 TWISTED PAIRS W/SHIELDING				
603	FLANGE ALUMINUM, .635 [16.13] Ø1.417 [36.0]	010	7	10	32	.5	1	16 SPREAD	AX	12 mm	.4724/.4735 [11.99/12.02] .635 [16.13] AOL	12	24 AWG FLYING LEADS		
		011	4.25	10	35	.47	3	8	AU	SPCL	SPECIAL, SEE DRAWING	19	29 AWG SILIFLEX FLYING LEADS		
604	SERVO GROOVE STEEL, .629 [16.0], Ø1.449 [36.80]	014	3.5	10	65	1	1	16 SPREAD	AY	1/4	.2500/.2510 [6.35/6.375] W/KEYWAY .635 [16.13] AOL	20	RADIATION HARDEN 26 AWG FLYING LEADS		
		018	7	8	45	.5	4	8 SPREAD							

SEE SHEET 3 FOR DIMENSIONAL DIFFERENCES

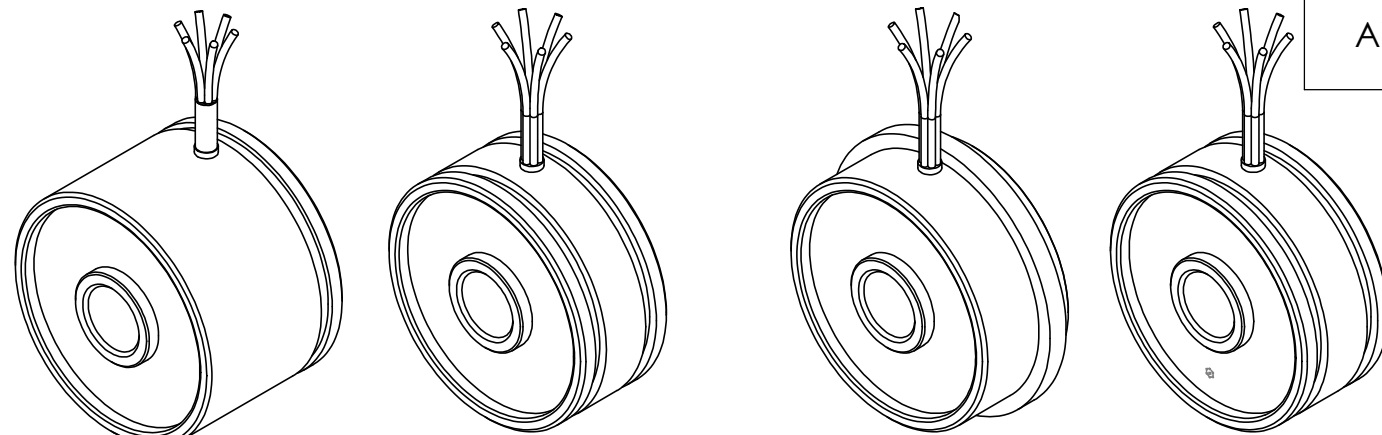

PILOT 600

PILOT 602

PILOT 603

PILOT 604

<p>THIRD ANGLE PROJECTION</p>	<p>UNLESS OTHERWISE SPECIFIED: DIMENSIONS ARE IN INCHES [mm] DIAMETERS CONCENTRIC .003 [0.076] TIR FACES PERPENDICULAR .003 [0.076] INSIDE CORNERS R .015 [0.381] MAX</p> <p>INTERPRETATION PER ASME Y14.5M-1994</p>	<p>UNLESS OTHERWISE SPECIFIED: REMOVE ALL BURRS AND BREAK SHARP EDGES -.005/0.010</p> <p>TOLERANCES: DECIMAL .00±0.01 [254], .000 ±.005 [127] ANGLE ±0.5° CHAMFER ANGLE ±10°</p> <p>MACHINE SURFACES 63</p>	<p><b>API DELEVAN</b> <a href="http://www.delevan.com">http://www.delevan.com</a></p>	
			<p><b>15BRCX</b></p>	
<p>MATERIAL</p> <p>FINISH</p>	<p>APPROVALS</p> <p>CHECKED</p> <p>DES ENG</p>	<p>DATE</p> <p></p>	<p>SCALE</p>	<p>DWG. NO.</p>
<p>THE INFORMATION CONTAINED IN THIS DRAWING IS THE SOLE PROPERTY OF API DELEVAN. ANY REPRODUCTION IN PART OR WHOLE WITHOUT THE WRITTEN PERMISSION OF API DELEVAN IS PROHIBITED.</p>			<p>SHEET 2 OF 3</p>	<p>CODE IDENT: 58655</p>

REVISIONS				
REV	ECO	DESCRIPTION	DATE	CHECKED
-	-	NEW DRAWING		

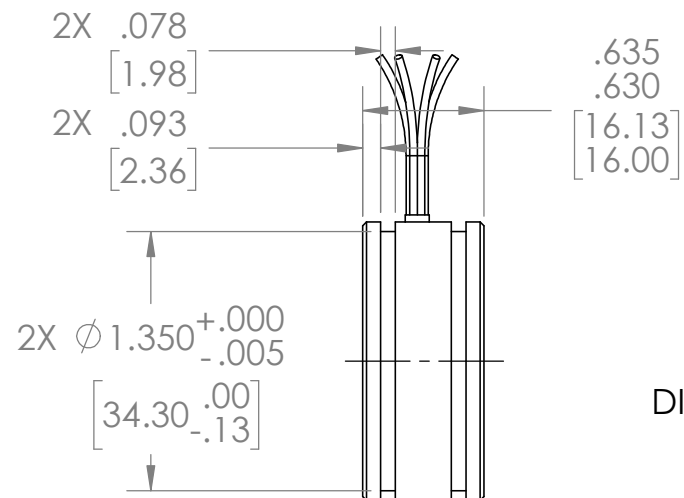

PILOT 602  
 DIMENSIONS  
 DIFFERENCES FROM 600

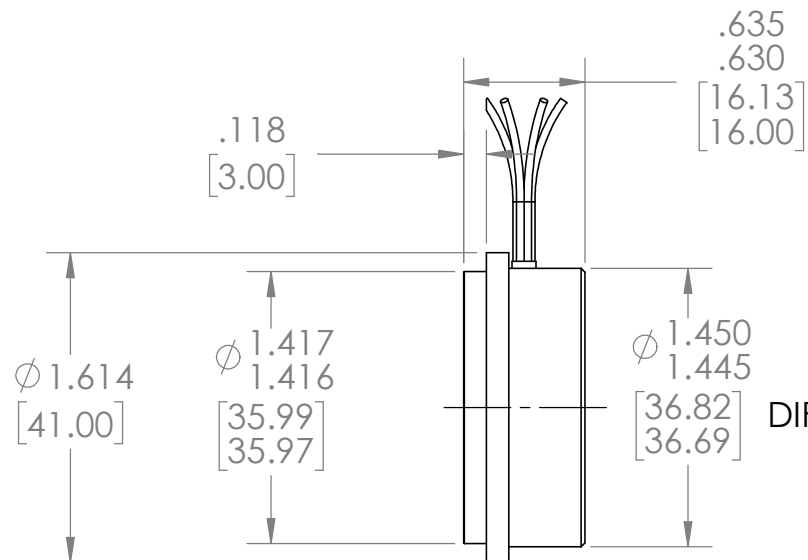
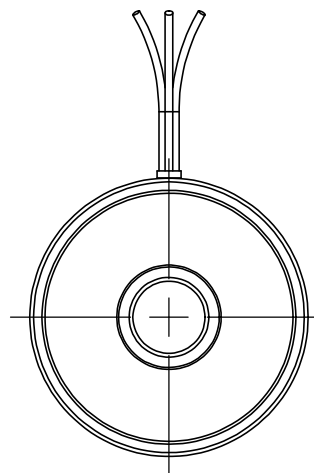

PILOT 603  
 DIMENSIONS  
 DIFFERENCES FROM 600

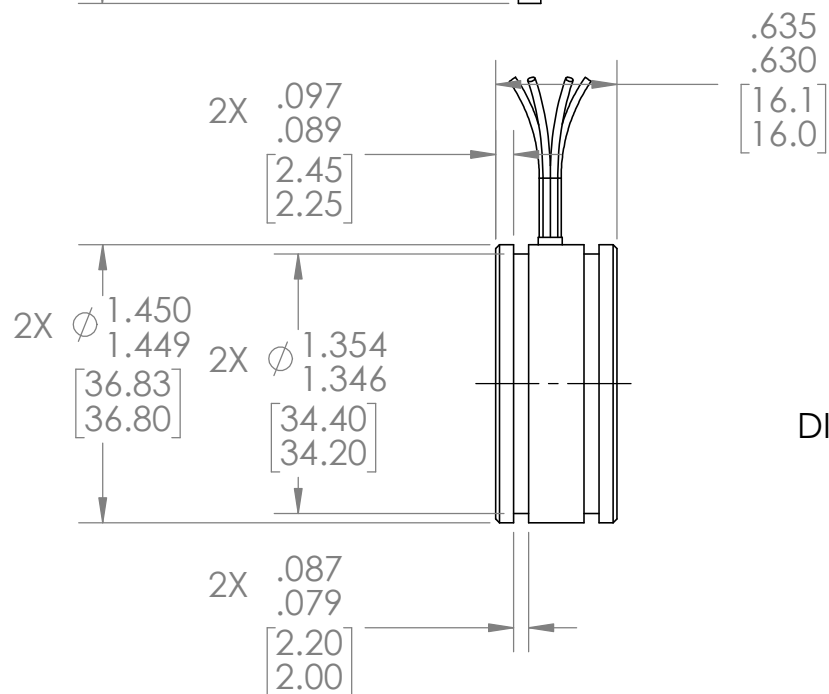
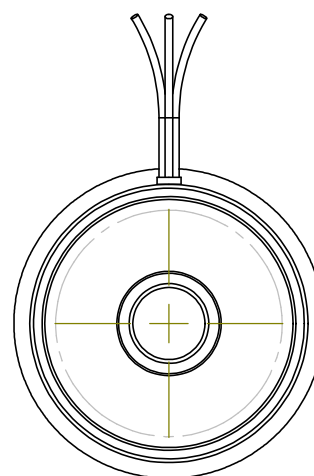

PILOT 604  
 DIMENSIONS  
 DIFFERENCES FROM 600

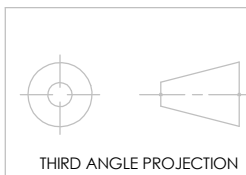
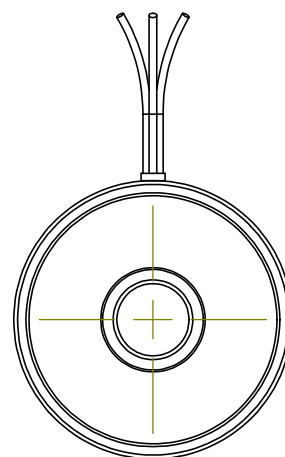

THE INFORMATION CONTAINED IN THIS DRAWING IS THE SOLE PROPERTY OF API DELEVAN. ANY REPRODUCTION IN PART OR WHOLE WITHOUT THE WRITTEN PERMISSION OF API DELEVAN IS PROHIBITED.

UNLESS OTHERWISE SPECIFIED:  
 DIMENSIONS ARE IN INCHES [mm]  
 DIAMETERS CONCENTRIC .003 [.076] TIR  
 FACES PERPENDICULAR .003 [.076]  
 INSIDE CORNERS R .015 [.381] MAX  
 INTERPRETATION PER ASME Y14.5M-1994

MATERIAL -  
 FINISH -

UNLESS OTHERWISE SPECIFIED:  
 REMOVE ALL BURRS AND BREAK SHARP EDGES -.005/.010  
 TOLERANCES:  
 DECIMAL .00±0.01 [.254] .000 ±.005 [.127]  
 ANGLE ±0.5°  
 CHAMFER ANGLE ±10°  
 MACHINE SURFACES 63

APPROVALS  
 DRAWN -  
 CHECKED -  
 DES ENG -

**API DELEVAN**  
<http://www.delevan.com>

**15BRCX**

SIZE B DWG. NO.  
 SCALE SHEET 3 OF 3 CODE IDENT: 58655