

NOTES:

1. ROTOR & STATOR ARE A MATCHED PAIR. DO NOT INTERCHANGE ROTOR OR STATOR BETWEEN RESOLVERS.
2. ROTOR AND STATOR TO BE MOUNTED AXIALLY FLUSH ± .010.
3. CUSTOMER MUST MAINTAIN SHAFT RUNOUT WITH RESPECT TO DATUM 'A' WITHIN .003 T.I.R.

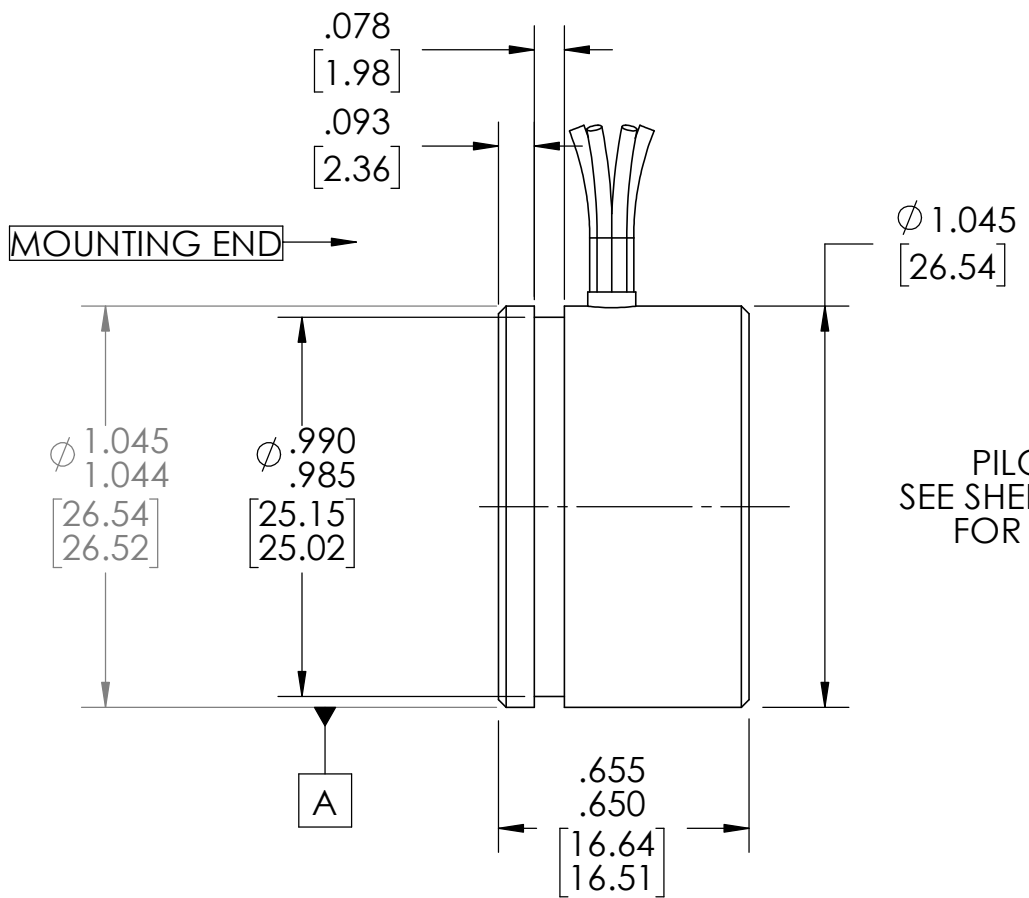

SEE SHEET TWO FOR LEAD OPTIONS

PILOT 401 SHOWN SEE SHEET TWO AND THREE FOR OTHER OPTIONS

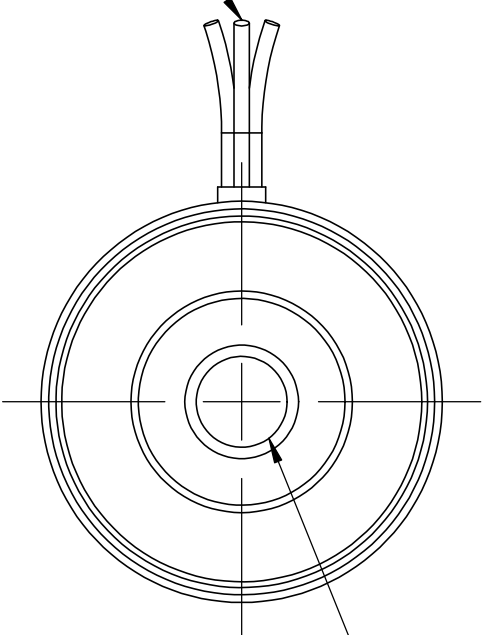

SEE SHEET TWO FOR BORE SIZES

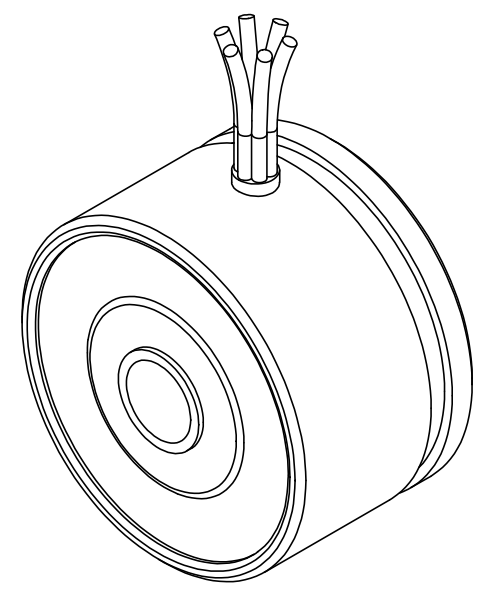

SCHEMATIC

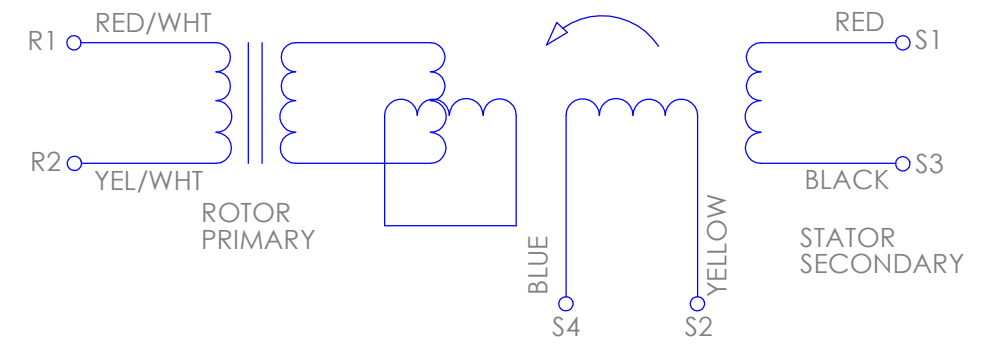

PHASING EQUATION

FOR CCW ROTATION OF ROTOR FACING TRANSFORMER MOUNTING FLANGE END.

$$E(S1-S3) = KE(R1-R2) \cos \varnothing$$

$$E(S2-S4) = -KE(R1-R2) \sin \varnothing$$

PART, ASSEMBLY AND ALL COMPONENTS MEET EU ROHS DIRECTIVE

<p>THIRD ANGLE PROJECTION</p>	<p>UNLESS OTHERWISE SPECIFIED: DIMENSIONS ARE IN INCHES [mm] DIAMETERS CONCENTRIC .003 [.076] TIR FACES PERPENDICULAR -.003 [.076] INSIDE CORNERS R .015 [.381] MAX INTERPRETATION PER ASME Y14.5M-1994</p>	<p>UNLESS OTHERWISE SPECIFIED: REMOVE ALL BURRS AND BREAK SHARP EDGES -.005/.010 [.127/.254]</p> <p>TOLERANCES: DECIMAL .00±.01 [.254] .000 ±.005 [.127] ANGLE 30.5° CHAMFER ANGLE ±10°</p>	<p>API Delevan</p>	
	<p>MATERIAL -</p> <p>FINISH -</p>	<p>MACHINE SURFACES 63</p> <p>APPROVALS - DATE -</p> <p>DRAWN -</p> <p>CHECKED -</p> <p>DES ENG -</p>	<p>SIZE B</p> <p>DWG. NO.</p>	<p>SCALE</p>

REVISIONS				
REV	ECO	DESCRIPTION	DATE	CHECKED
-	-	NEW DRAWING		

NUMBERING

10BRCX-XXX-XXXX-XXXX

SIZE
10

STYLE OF RESOLVER:
FRAMELESS

PILOT NUMBER	STYLE	WINDING NUMBER	Vrms	KHz	ma m Ar ms	Tr	SPEED	ACCURACY ±arcmin	BORE LETTER	BORE	"B" DIAMETER	CABLE DESIGNATION	CABLE	LEAD	LENGTH
														01	12[305]
401	SINGLE GROOVE, Ø1.04[26.416], RADIAL LEADS	001	7	10	50	.50	1	20	A	1/4 INCH	.2500/.2510[6.35/6.375]	02	28 AWG FLYING LEADS	01	12[305]
		002	4	5	43	.50	1	15	B	6 mm	.2362/.2370[6.000/6.020]	06	28 AWG 3 TWISTED PAIRS	02	16[406]
		003	4	5	432	.50	1	20	J	4mm	.1575/.1580[4.000/4.015]	07	28 AWG FLYING LEADS W/TUBING	03	24[609]
403	SINGLE GROOVE, Ø1.04[26.416] AXIAL LEADS	004	7	10	50	.50	1	15				08	28 AWG HIGH TEMP FLYING LEADS	04	60[1524]
		008	7	5	70	.50	1	15				09	24 AWG 3 TWISTED PAIRS	05	80[2032]
		009	4.25	7	55	.47	1	15				11	22 AWG 4 TWISTED PAIRS W/TUBING	06	120[3048]
405	MOUNTING EARS, Ø.988[25.010] RADIAL LEADS	010	7	10	30	.50	1	30				20	RADIATION HARDEN 26 AWG FLYING LEADS		
		014	3.5	10	65	1.0	1	30							
406	NO GROOVE, Ø.984[25.00] RADIAL LEADS	021	4.7	2.7	55	.475	1	15							
411	SINGLE GROOVE, Ø1.000[25.400], RADIAL LEADS														

SEE SHEET 3 FOR DIMENSIONAL DIFFERENCES

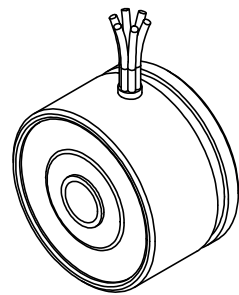

PILOT 401

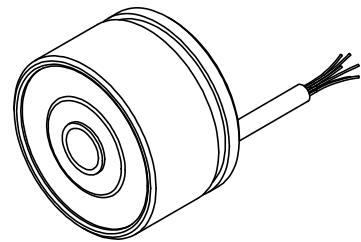

PILOT 403

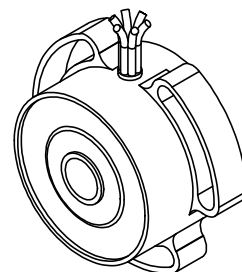

PILOT 405

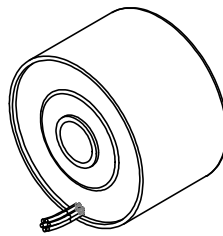

PILOT 406

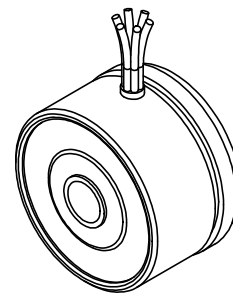

PILOT 411

<p>THIRD ANGLE PROJECTION</p>	<p>UNLESS OTHERWISE SPECIFIED: DIMENSIONS ARE IN INCHES [mm] DIAMETERS CONCENTRIC .003 [.076] TIR FACES PERPENDICULAR .003 [.076] INSIDE CORNERS R .015 [.381] MAX</p> <p>INTERPRETATION PER ASME Y14.5M-1994</p>	<p>UNLESS OTHERWISE SPECIFIED: REMOVE ALL BURRS AND BREAK SHARP EDGES -.005/.010</p> <p>TOLERANCES: DECIMAL .00±.01 [.254] .000 ±.005 [.127] ANGLE ±0.5° CHAMFER ANGLE ±10°</p> <p>MACHINE SURFACES 63</p>	<h2>API Delevan</h2> <h1>10BRCX</h1>
<p>MATERIAL</p> <p>FINISH</p>	<p>APPROVALS</p> <p>CHECKED</p> <p>DES ENG</p>	<p>DATE</p> <p>DATE</p>	<p>SIZE DWG. NO.</p> <p>B</p>
<p>SCALE</p>		<p>SHEET 2 OF 3</p>	<p>CODE IDENT: 58655</p>

D
C
B
A

D
C
B
A

8 7 6 5 4 3 2 1

8 7 6 5 4 3 2 1

REVISIONS					
REV	ECO	DESCRIPTION	DATE	BY	CHECKED
-	-	NEW DRAWING			

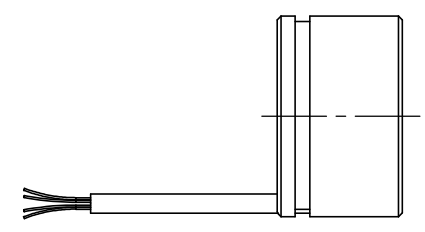

PILOT 403
DIMENSIONS
SAME AS 401

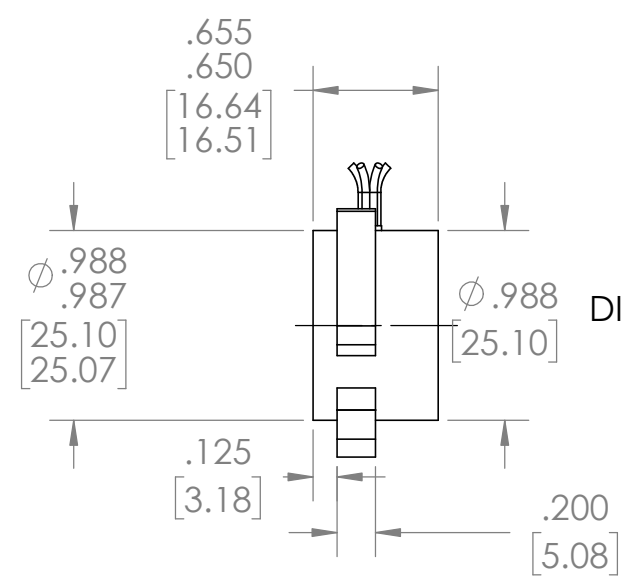
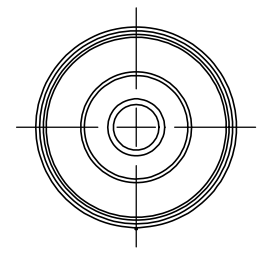

PILOT 405
DIFFERENCES FROM 401

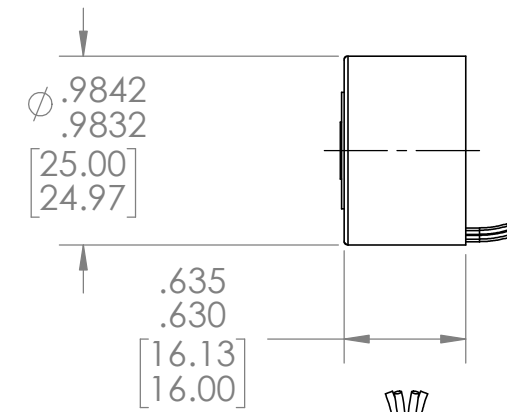
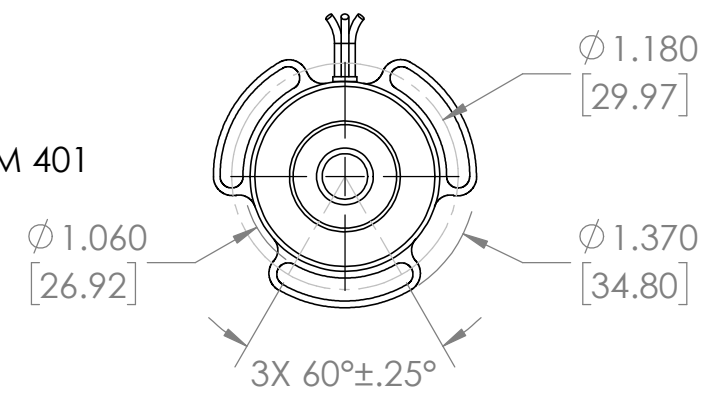

PILOT 406
DIFFERENCES FROM 401

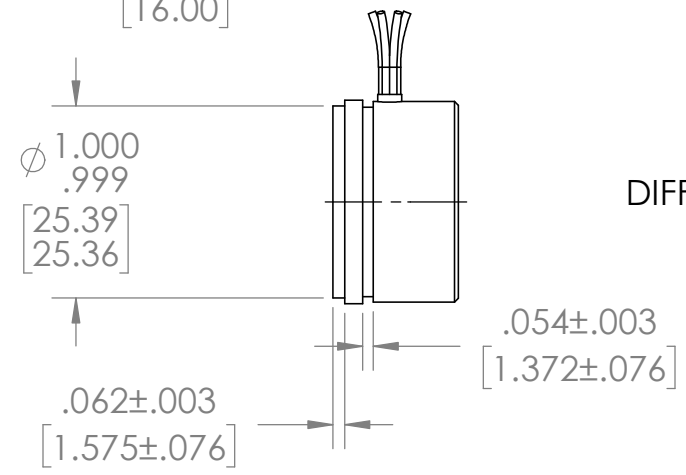
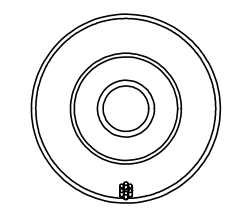

PILOT 411
DIFFERENCES FROM 401

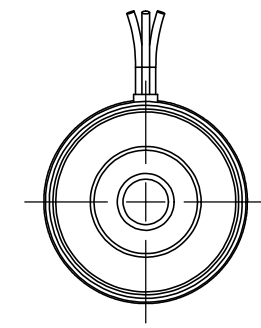

<p>THIRD ANGLE PROJECTION</p>	<p>UNLESS OTHERWISE SPECIFIED: DIMENSIONS ARE IN INCHES [mm] DIAMETERS CONCENTRIC .003 [.076] TIR FACES PERPENDICULAR .003 [.076] INSIDE CORNERS R .015 [.381] MAX INTERPRETATION PER ASME Y14.5M-1994</p>	<p>UNLESS OTHERWISE SPECIFIED: REMOVE ALL BURRS AND BREAK SHARP EDGES -.005/.010</p> <p>TOLERANCES: DECIMAL .00±.01 [.254] .000 ±.005 [.127] ANGLE ±0.5° CHAMFER ANGLE ±10°</p>	<h1>API Delevan</h1>	
	<p>MATERIAL -</p> <p>FINISH -</p>	<p>MACHINE SURFACES 63</p> <p>APPROVALS - DATE -</p> <p>DRAWN -</p> <p>CHECKED -</p> <p>DES ENG -</p>	<h1>10BRCX</h1>	
<p>THE INFORMATION CONTAINED IN THIS DRAWING IS THE SOLE PROPERTY OF API DELEVAN. ANY REPRODUCTION IN PART OR WHOLE WITHOUT THE WRITTEN PERMISSION OF HAROWE IS PROHIBITED.</p>			<p>SIZE B DWG. NO.</p>	<p>SHEET 3 OF 3</p>
			<p>SCALE</p>	<p>CODE IDENT: 58655</p>